

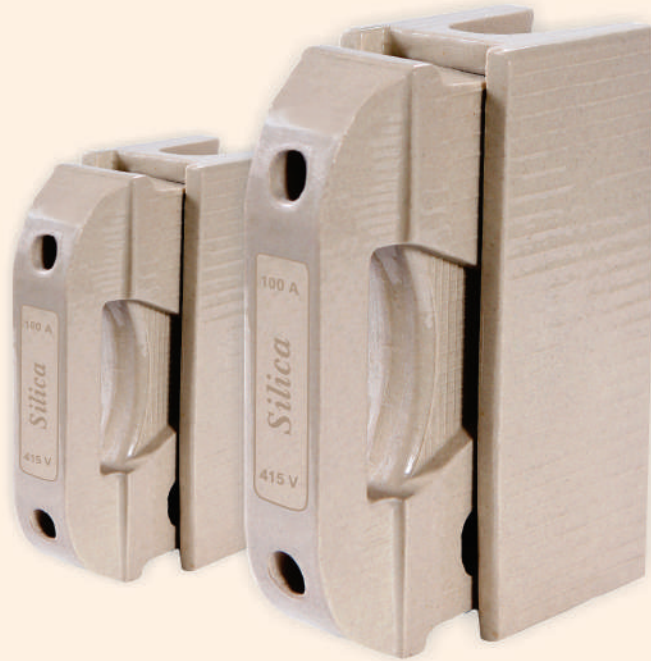

# Silica®

**KIT KAT FUSE UNIT**

[www.silicaindia.com](http://www.silicaindia.com)



**50Hz**



FOLLOW US ON:



ISO 9001:2015  
CERTIFIED COMPANY

सिलिका मिछीवा नरयणीव त्तुत्तुत्तु SILICA सीलिका SILIKA 0.8.1 आगनुये धातव पदार्थवशिष्ये السيلیکا





## INTRODUCTION

Hello,

I have pleasure to introduce myself as the founder of the group of companies Called “**Silica Group**”, located at prime location in the country i.e, New Delhi, in INDIA.

The Group was established in the year 1991-1992 and have specialized the in the Manufacturing of a range of items used in Industrial & Domestic Sectors. Our product range include Whole range of Switch Gear, Wire & Cables, Electrical Accessories, Home Appliances, Public Address System, Mobile Phone Accessories, Electricity Generators, LED's, Etc. Further, our group extended its range of manufacturing Fans, Lighting Fittings, Electrical measuring instruments such as Voltmeter, Energy Meter etc. Encouraged by the good marked response to these products, the group embarked on further enlarging the scope to include manufacturing of the full range of Miniature Circuit Breakers (MCB's), water pump, etc. Today, Our group has established itself as one of the prime manufacturers and suppliers of Electrical Items, both in the domestic as well as in the Global Market. We feel proud to mention that our group is successful in capturing the export markets of the Gulf, African & Asian Countries.

Our manufacturing premises is a well-modernised plant with various special purpose tools & machines installed for manufacturing the various range of products. It is a matter of delight for me to mention that nearly around 100000 Nos. of components are being turned out from manufacturing units for their ultimate use in the end products.

In this highly competitive market, we are able to sustain and progressively register increased sales volume year after year; merely because of **TOTAL COMMITMENT to TOTAL QUALITY MANAGEMENT** at every stage of Manufacturing till the goods are delivered to our esteemed buyers. Quality audits and stringent checks are built into our quality control so as to maintain highest levels of quality of our products.

Looking forward of your esteemed organization & assuring you the best services at all times from our side.

With Regards,

**AJAY KUMAR JAIN**

## EXPORT

TANZANIA SUDAN NIGERIA GHANA ETHIOPIA BANGLADESH KENYA KUWAIT  
YEMEN QATAR CONGO OMAN SRI LANKA U.A.E. MYANMAR



सिलिका मिश्रीवा नरयणीव त्त चत्त SILICA सीलिका SILIKA ᱵᱟᱨᱜᱟᱴ आग्नये धातव पदारथवशिषे السيليكا



# FUSE LINK & FUSE BASE

## CONSTRUCTION

### FUSE HOLDERS

Open type fuse bases are available for mounting of DIN type fuse links in current rating 16A, 32A, 63A, 100A, 200A, 320A, 400A, and 500A. These fuse holders/fuse bases conform to As Per IS:13703 & IEC:60269 Specification.

### Moulding (Casing)

The Fuse Holders/Bases are manufactured from high grade porcelain. These Are non-inflammable, non-hygroscopic and with hard glossy finish.

### Contacts

Current carrying parts of the holders are made from precisely pressed copper/brass material and have extruded brass base contacts. These are mounted on moulded seats to ensure perfect alignment. The current carrying parts of the fuse bases are electro plated with silver to ensure long life, non-deteriorating contact surface for high efficiency mating.

### Back up Clips

Back up pressure clips have been precisely formed from Phosphor Bronze/Spring Steel materials to ensure perfect mating of male and female parts, for long life.

### Terminals

Copper/Brass terminals are used for direct cable termination in case of enclosed type Fuse Holders and through Cable lugs for open type Fuse Bases complete with Cable holding fasteners.

### Fuse puller

They are used for safe removal of fuses and protection against accidental contact with live parts during maintenance.



## Domestic



Current Rating (A)	Cat. No.
16	PFHD0016
20	PFHD0020
32	PFHD0032
63	PFHD0063

## Industrial



Current Rating (A)	Cat. No.
63	PFHI0063
100	PFHI00100
200	PFHI00200
320	PFHI00320
400	PFHI00400
500	PFHI00500

# KIT KAT FUSE UNIT

Domestic

DIMENSIONS (IN MM)

Industrial

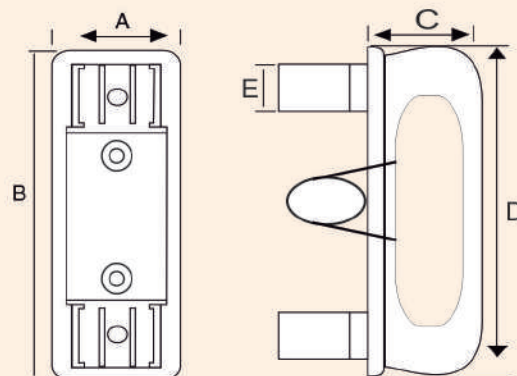
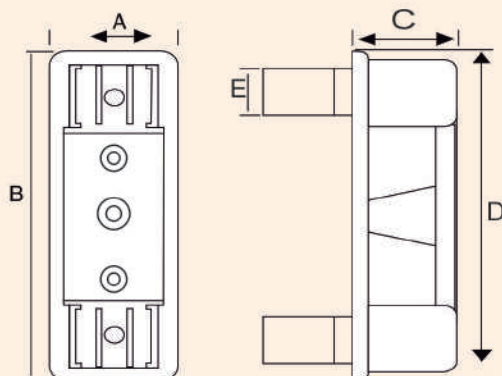

Rating	A	B	C	D	E	F	Size for Cable entry & exit	Size of Al. conductor	Size of knock-out
Domestic									
16A	210	205		172	154	165	„	4 mm <sup>2</sup>	25.4
32A	210	217	103	166	173	169	„	16 mm <sup>2</sup>	25.4
63A	47	130	40	130	16		„	25 mm <sup>2</sup>	38
100A	400	320	141	338	258	245	366x60	50 mm <sup>2</sup>	38
200A	425	495	240	322	390	400	„	150 mm <sup>2</sup>	
320A	425	495	240	322	390	400	„	240 mm <sup>2</sup>	
Industrial									
63A	47	130	40	130	16		„	25 mm <sup>2</sup>	38
100A	62	165	53	165	19		366x60	50 mm <sup>2</sup>	38
200A	63	185	50	185	25		„	150 mm <sup>2</sup>	
320A	425	495	240	322	390	400	„	240 mm <sup>2</sup>	
400A	515	595	314	545	480	418			
500A	515	595	314	545	480	418			

## Features

## KIT KAT FUSE UNIT

- ★ Porcelain Kit Kat 16 Amp to 63 Amp. with out handle & 63 Amp. to 500 Amp. with handle.
- ★ Contacts are Silver / Nickel plated to ensure high conductivity & longer life.
- ★ Manufactured with porcelain and bakelite molded making.
- ★ High quality copper & brass contacts for long life operation .
- ★ Bakelite Kit Kat 16 Amp. to 100 Amp. without handle .
- ★ As per IS:2086/1993. (Reaffirmed 1998) specifications.
- ★ Best use for Domestic & Industrial.

### TYPE

- ★ With bus bar
- ★ Without bus bar

Rating : 16/20/32/63/100/200/320/500 Amp.  
 Rated Voltage : 240/415 Volt.  
 Execution : SP.



# FUSE LINK & FUSE BASE

## CONSTRUCTION

### FUSE HOLDERS / FUSE BASES

Fuse Holders, enclosed type, are available for Bolted type fuse links in current ratings 20A, 32A, 63A, 100A and 125A with provision for front and bus bar connection.

Open type fuse bases are available for mounting of DIN type fuse links in current rating 100A, 125A, 160A, 250A, 400A and 630A.

These fuse holders/fuse bases conform to As per IS:13703 & IEC:60269 specification.

### Moulding (Casing)

The Fuse Holders/Bases are manufactured from high grade phenol formaldehyde/Polyester resin based vinyl moulding compound. These are non-inflammable, non-hygroscopic and with hard glossy black finish.

### Contacts

Current carrying parts of the holders are made from precisely pressed copper/brass material and have extruded brass base contacts. These are mounted on moulded seats to ensure perfect alignment. The current carrying parts of the fuse bases are electro plated with silver to ensure long life, non-deteriorating contact surface for high efficiency mating.

### Back up Clips

Back up pressure clips have been precisely formed from Phosphor Bronze/Spring Steel materials to ensure perfect mating of male and female parts, for long life.

### Terminals

Copper/Brass terminals are used for direct cable termination in case of enclosed type Fuse Holders and through Cable lugs for open type Fuse Bases complete with Cable holding fasteners.

### Fuse puller

They are used for safe removal of fuses and protection against accidental contact with live parts during maintenance.



## FUSE HOLDERS / BASES

### DIMENSIONS (IN MM) FUSE HOLDERS

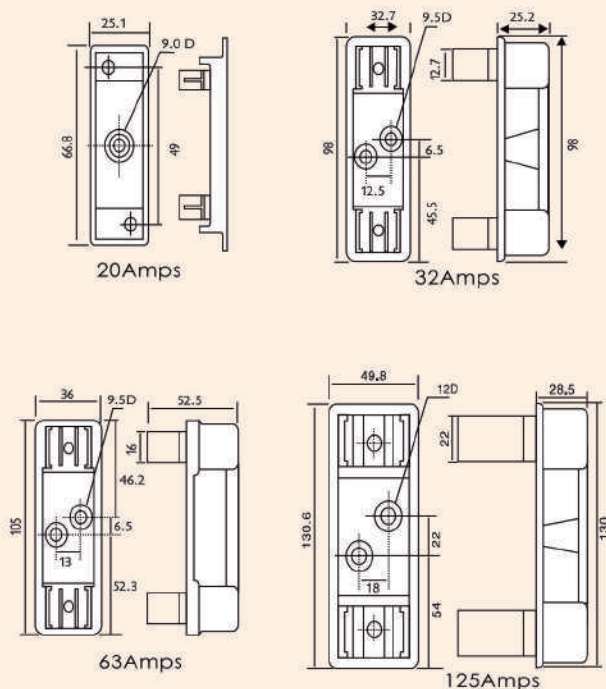

Current Rating (A)	Type	Cat. No.
20A	Front /Bus Bar Connection	BONS*020
32A	Front/Bus Bar Connection	BTIA*032
63A	Front/Bus Bar Connection	BTSS*063
100A	Front Connectio	BTSD*100
100A	Open Fuse Base	BC00O100
125A	Open Fuse Base	BC00O125
160A	Open Fuse Base	BC00O160
250A	Open Fuse Base	BC01O250
400A	Open Fuse Base	BC02O400
630A	Open Fuse Base	BC03O630

\* H for Front Connection; B for Bus Bar Connection





## KIT KAT FUSE UNIT

Scan the QR Code  
to download  
SILICA Catalogue



HEAD OFFICE :- SILICA GROUP

ADD :- 2654, STREET NO.6, BIHARI COLONY, SHAHDARA,  
DELHI - 110032, INDIA

CONTACT NO. :- +91-9312606510, 9999459122, 8800376242

Customer Care No. - +91 9910496097

Email id :- Silicaindia@yahoo.co.in, Luksuninternational@gmail.com

Website - Silicaindia.com, Silicapower.com



सिलिका सिलिका नरयटीव डी.सी.टी. SILICA सिलिका SILIKA SILIKA आग्नये धातव पदार्थवशिष्ये السيليكا